

FLOOR PLAN

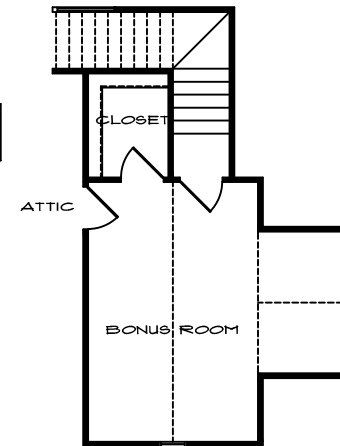

BONUS FLOOR PLAN

SQUARE FOOTAGE CALCULATIONS

FIRST FLOOR - 2132 S.F.
SECOND FLOOR - 392 S.F.
TOTAL LIVING S.F. - 3124 S.F.
TOTAL SLAB - 4215 S.F.



FRONT ELEVATION