

FLOOR PLAN

SCALE: 1/4" = 1'-0"

SQUARE FOOTAGE CALCULATIONS

FIRST FLOOR	- 2253 S.F.
BONUS	- 492 S.F.
TOTAL LIVING S.F.	- 2743 S.F.
TOTAL SLAB	- 3654 S.F.

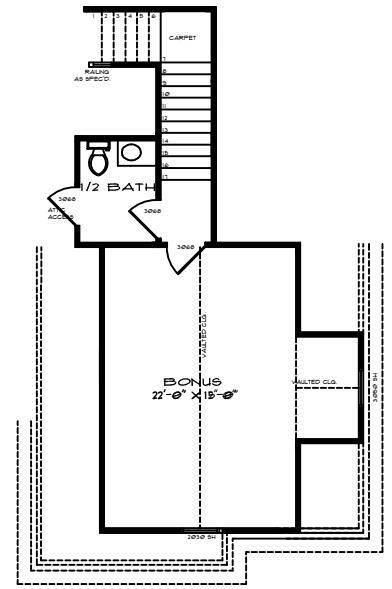

BONUS FLOOR PLAN

SCALE: 1/4" = 1'-0"



FRONT ELEVATION

SCALE: 1/4" = 1'-0"