

FLOOR PLAN

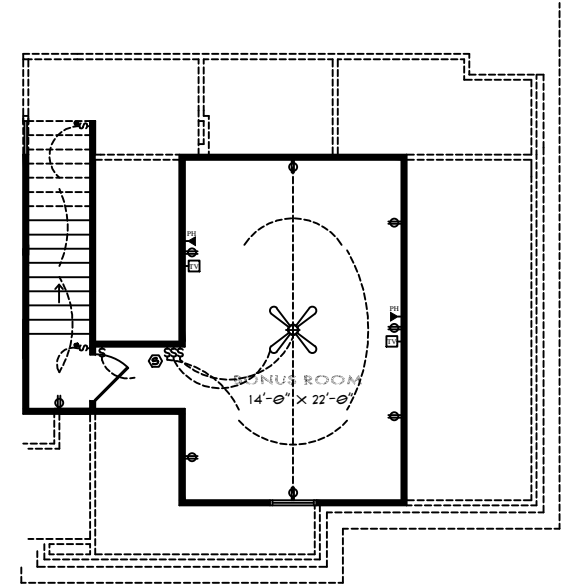

BONUS PLAN

SQUARE FOOTAGE CALCULATIONS

FIRST FLOOR - 2192 S.F.
SECOND FLOOR - 311 S.F.
TOTAL LIVING S.F. - 2503 S.F.
TOTAL SLAB - 3440 S.F.



FRONT ELEVATION