

FLOOR PLAN

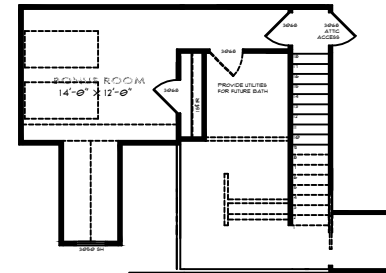

BONUS PLAN

SQUARE FOOTAGE CALCULATIONS

FIRST FLOOR - 3091 S.F.
SECOND FLOOR - 238 S.F.
TOTAL LIVING S.F. - 3355 S.F.
TOTAL SLAB - 5549 S.F.



FRONT ELEVATION