

SQUARE FOOTAGE CALCULATIONS

1ST FLOOR LIVING	- 2202 S.F.
BONUS	- 430 S.F.
TOTAL LIVING S.F.	- 2632 S.F.
BACK PORCH	- 253 S.F.
FRONT PORCH	- 171 S.F.
GARAGE	- 600 S.F.
BONUS ROOM	- 430 S.F. (T.B.D.)
MASONRY LUG	- 155 S.F.
TOTAL SLAB	- 3461 S.F.

FLOOR PLAN

SCALE: 1/4" = 1'-0"

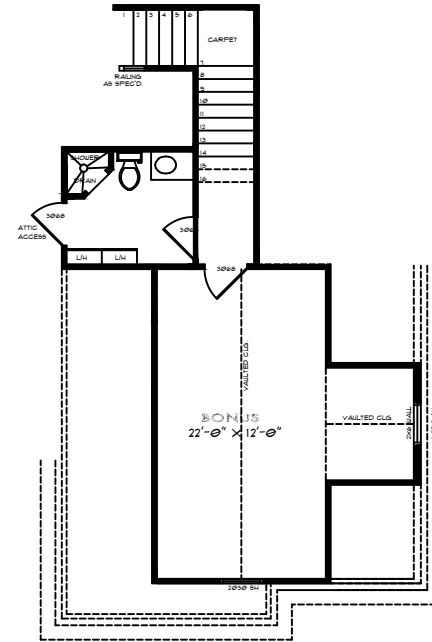

BONUS FLOOR PLAN

SCALE: 1/4" = 1'-0"



FRONT ELEVATION

SCALE: 1/4" = 1'-0"